

620 TERMINAL WAY • P. O. BOX 938 • COSTA MESA, CALIFORNIA 92627 • (714) 642-1163

IMPORTANT: AN "N" SERIES QUICK SPOOL WILL NOT FIT THIS REEL.

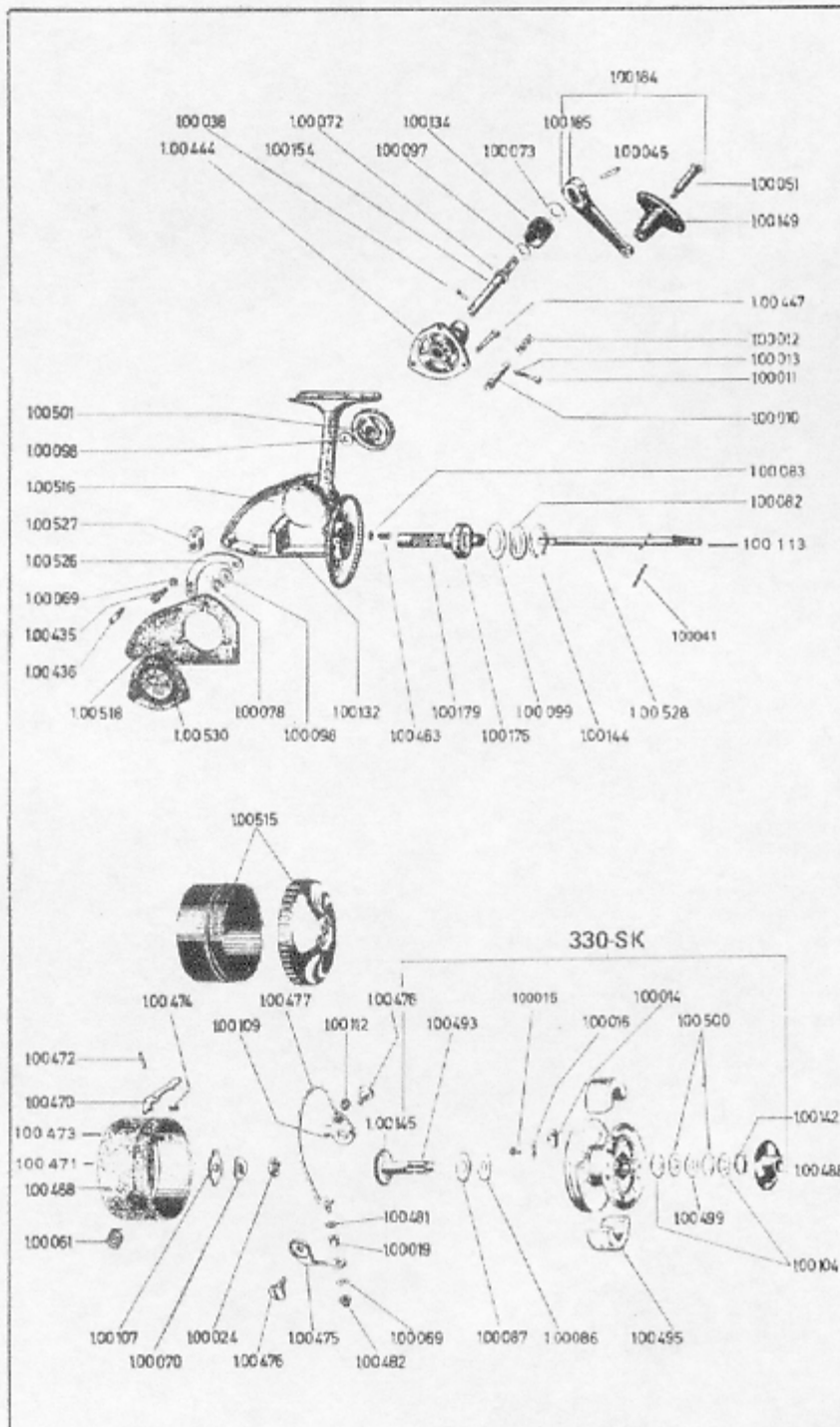

PART NO.	DESCRIPTION	LIST PRICE
100-010	Anti-reverse pin	
100-011	Ball lever	
100-012	Spring	
100-013	Plastic tubing	
100-014	Click tongue	
100-015	Pin	
100-016	Spring	
100-019	Line guide	
100-024	Hexagon nut	
100-038	Pin for drive gear	
100-041	Pin for axle	
100-045	Pin for crank arm	
100-051	Grip screw	
100-061	Ball spring	
100-069	Lock washer	
100-070	Spring washer	
100-072	Safety clip	
100-073	Washer	
100-078	Safety clip	
100-082	Spring washer	
100-083	Washer	
100-086	Washer (metal)	
100-087	Washer (resitex)	
100-097	Washer	
100-098	Washer	
100-099	Packing ring	
100-104	Washer (metal)	
100-107	Driving plate	
100-109	Rubber buffer	
100-112	Cover cap	
100-113	Axle spool catch	
100-132	Bearing bushing for housing	
100-134	Crank nut	
100-142	Snap ring	
100-144	Snap ring	
100-145	Ratchet Wheel	
100-149	Handle grip	
100-154	Drive axle	
100-176	Ball bearing	
100-179	Drive shaft	
100-184	Crank arm, complete	
100-185	Crank arm	
100-435	Screw for slide	
100-436	Screw for axle	
100-444	Bearing cover	
100-447	Screw for bearing cover	
100-463	Ball trip screw	
100-468	Rotating head	
100-470	Trip lever	
100-471	Trip lever holder	
100-474	Rivet for P/N 100-471	
100-472	Bearing pin	
100-474	Spring for stop lever	
100-475	Angle lever	
100-476	Bearing screw	
100-477	Ball	
100-481	Washer	
100-482	Hexagon nut	
100-488	Drag nut	
100-493	Brake spindle w/o ratchet wheel	
100-495	Cork ring halves (2)	
100-499	Drive plate	
100-500	Washer	
100-501	Drive gear	
100-515	Plastic box for line spool	
100-516	Housing	
100-518	Housing cover	
100-526	Slide	
100-527	Connecting piece	
100-528	Axle, complete	
100-530	Side plate cover	
100-515	Spool box, plastic	
ADDITIONAL SPARES FOR HIGH SPEED REEL NO. 331		
S100-206	Drive shaft	
S100-208	Crank assembly, complete	
S100-209	Crank arm	
S100-521	Side plate cover	
S100-522	Drive gear	
330SK	Spool, complete	